

Light Valance Instructions

Follow these instructions for proper installation of your light valance.

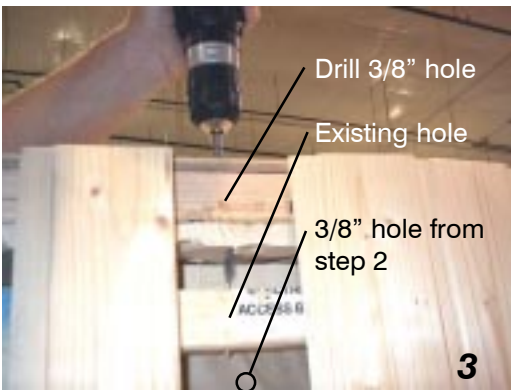

1. On the exterior of one of your wall panels note an Electrical Access which consists of a missing piece of T&G (tongue & groove) which will later be installed after step 6.

2. On the corresponding piece of T&G on the interior of the room, measure down 5" and drill a 3/8" hole into the panel centered horizontally on this piece of T&G.

3. With your ceiling in place, drill a 3/8" hole through the ceiling making sure the hole is aligned with the existing holes visible from your access panel.

4. From the interior of the room, feed the 2 wires from your light valance through the 3/8" hole in the wall, out through the electrical access, (moving the insulation aside) and up through the 3/8" hole in the ceiling panel.

5. Making sure your valance is level, position it on your wall with the top about 3" from the ceiling and fasten it with the screws provided with your transformer.

6. Mount your transformer on the ceiling so it is inconspicuous and refer to its documentation for proper wiring.

7. Re-pack your insulation and install your electrical access board, tacking it into place with finishing nails.