

○ CUSTOM INFRARED

| ○ PREFAB I/S

| ○ PASSPORT I/S

2-in-1 Combination *Infrasauna*



INFRASAUNA™

InfraSauna™

CUSTOM INFRARED SAUNA ROOMS AND 2-IN-1 COMBINATION TRADITIONAL FINNISH SAUNA PLUS FAR-INFRARED



As infrared saunas have grown in popularity, two questions often emerged: “Can I get a CUSTOM infrared sauna made to fit my own design ideas?” and “Can I combine infrared with a traditional sauna heater?”

Now, happily the answer to both questions is an emphatic “Yes!” Saunatec’s new InfraSauna™ (I/S) is an industry first—an ETL safety listed product line that offers the following:

- *Custom Infrared sauna on your framed walls (see p. 4)*
 - *Build new or convert an existing sauna into I/S or IR*
- *Custom designed Modular/Prefab I/S or IR-only (see p. 6)*
- *Passport Series Saunas with IR added (see p. 8)*

your spouse prefers infrared sauna?

No problem. On weekends you like a traditional sauna taken with others—and with lots of steam—but during the work week you like mild/soothing infrared sauna heat therapy? No problem. The InfraSauna™ by Saunatec® is the ultimate sauna—a blending of our Traditional Finnish Saunas with our CarbonFlex® Infrared Technology.

This wonderful combination room provides pleasure beyond what a traditional or infrared sauna can do individually. Saunatec’s CarbonFlex® far-infrared heating system can be incorporated into virtually any sauna room design.

Let your imagination go. For the first time in the worldwide sauna industry, there are now IR options to give you exactly what you want.

CarbonFlex®

CUSTOM AND FLEXIBLE:

The I/S sauna provides the best of both worlds. You like traditional sauna but



CarbonFlex® InfraSauna Panel & Control Kit



Passport I/S Interior

*Solace I/S 6'x7', shown with
red color light therapy; note
traditional sauna heater on
back wall*

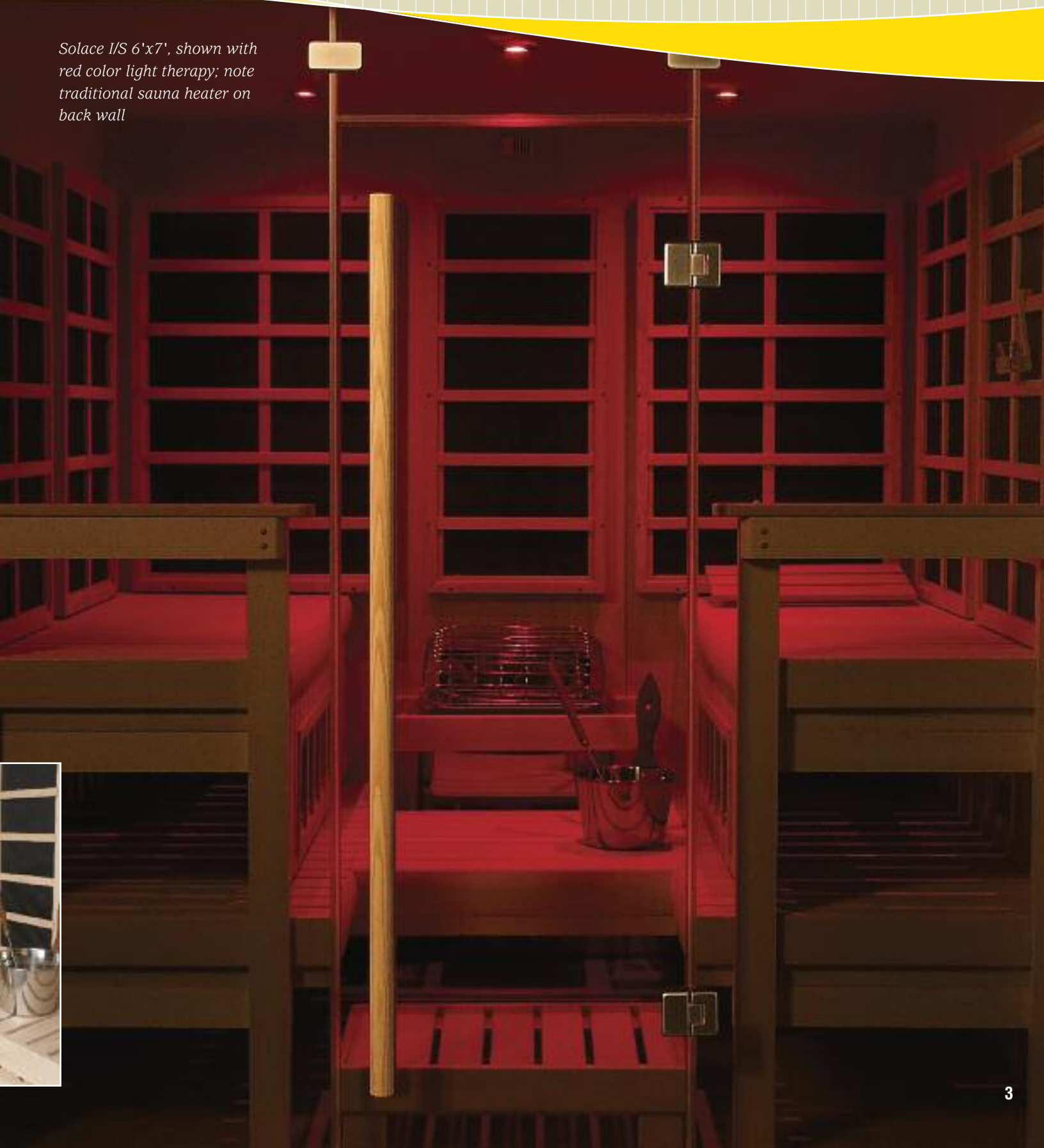

Infrasauna™

CUSTOM INFRARED ON YOUR FRAMED WALLS

New construction

Convert existing sauna into Infrared-only and InfraSauna



Custom Infrared, 6'x6'

A Custom Infrared Sauna, an option previously unavailable, will meet your special needs. Where IR was once limited to a few fixed sizes and models—now Custom Infrared and Custom InfraSauna™ are available in limitless shapes and sizes; you are limited only by your design imagination.

NEW CONSTRUCTION—TRULY “CUSTOM” INFRARED AND INFRA-SAUNA
The options with our Custom IR/IS are endless...with innovative use of glass windows and all-glass doors, angles, curves, special lighting and sound systems. Your design (or with our free design service incorporating your ideas), in partnership with Saunatec experience and quality, assures unmatched form and function.

Handcrafted to your plan, we'll precut the finest hand-selected wood for your walls and ceiling, we'll pre-build the benches and door, and include a CarbonFlex® IR Panel Kit sized for your room—all for installation on your framed walls. Simply provide the inside dimensions of the framed walls, the door location and your preference for bench configuration—and we'll do the rest. Need design assistance to overcome potential challenges? Visit with your local specialty Saunatec dealer, or call or email us.

Custom Infrared Saunas and Custom Infra-Saunas are perfect for new construction or remodeling: residential, hotels, health clubs, condos and apartments.

CONVERT AN EXISTING SAUNA ROOM INTO AN INFRA-SAUNA™



Before



After

Is your existing sauna tired and in need of a face lift? Perhaps it has been relegated to the role of store room? Maybe you've tried an Infrared Sauna somewhere and you'd like to have one at home—but don't want to have a second sauna?

With our Custom InfraSauna™ you can now convert your existing sauna into an upgraded sauna room with CarbonFlex far-infrared heating system combined with a

traditional sauna heater—with both heating systems easily controlled with the SaunaLogic™ digital/programmable control.



SaunaLogic™

Or, if you prefer only Infrared, you can convert your existing sauna room into an “Infrared only” sauna room—and still have the option to later add a traditional sauna heater.

The CAD layouts shown are only examples; unlimited custom shapes and sizes are available for Custom IR/IS saunas.

CC IS46, 4'x6'

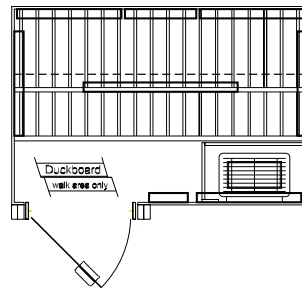

CC IS57, 5'x7'

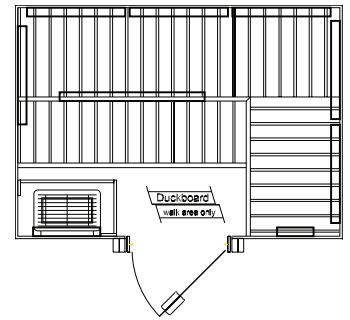

CC IS68, 6'x8'

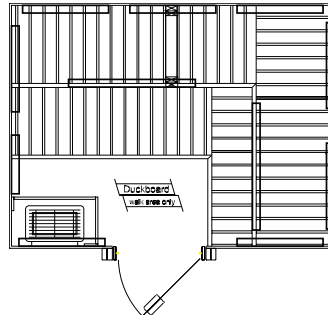

CC IS66, 6'x6'

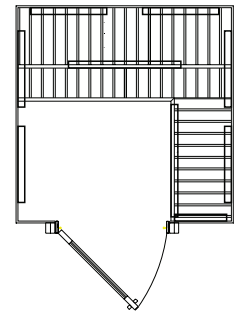

InfraSauna™

MODULAR, FREE STANDING, CUSTOM INFRARED AND INFRA SAUNA



Saunatec's InfraSauna option can be included in our modular Designer Saunas or in our standard prefab saunas—or can be customized to fit your design criteria.



Color Light Therapy System and Sound System Available with all I/S Systems

Easy to install on almost any level, waterproof surface, these modular beauties are ideal for residential or commercial installations. Available in unlimited designs and sizes—from personal size to 6 person saunas—they complement an in-home fitness center, a master bath suite, or perform superbly even in rugged commercial environments.

THE MODULAR INFRA SAUNA™ COMBINATION ROOM INCLUDES:

- CarbonFlex® heating panel kit (# of panels depends upon room size), with each IR heating panel enclosed in a case made of clear, vertical grain Canadian Hemlock.

- Stainless Steel Sauna Heater with SaunaLogic digital control (Junior heater for saunas less than 150 cubic feet; Viki heater for saunas up to 420 cu. Ft.).
- Wall and Ceiling prefabricated panels, hand crafted from a select sauna wood of your choice.
- Pre-assembled benches, selected from standard bench designs or choose a luxury upgrade such as Sunburst.
- Lighting system of your choice.
- Bucket, ladle, thermometer, rocks
- Loads of options: Glass features from expansive glass wall panels to round port-hole windows; a wide range of bench designs; lighting systems from recessed puck lights, LED and Fiber Optic systems, Color Light Therapy Systems, iPod Locker/Sound System.



Interior View, Modular, PB IS46, 4'x6'



Modular I/S with Color Light Therapy



Amberlight IS77, 7'x7'

InfraSauna PB IS67, 6'x7'; all-glass front



Amberlight IS77, 7'x7'

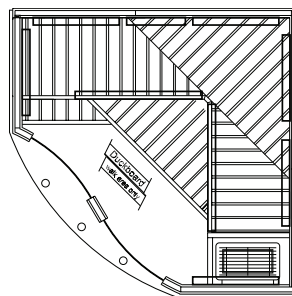

PB IS68, 6'x8'

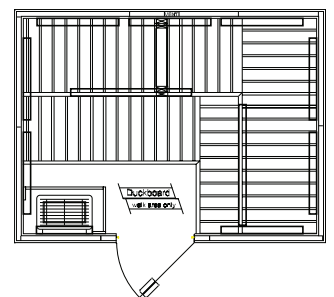

PB IS57, 5'x7'

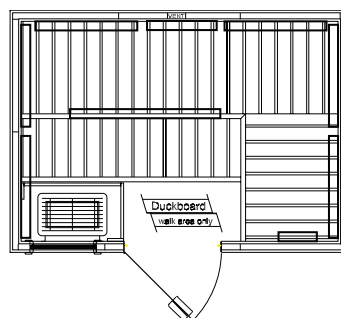

PB IS67, 6'x7'

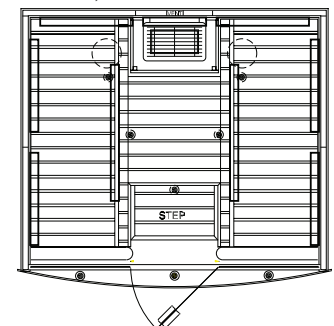

PB IS67. Note traditional heater on back wall.

Infrasauna™

PASSPORT PREFAB SAUNAS WITH INFRARED ADD-ON



PS-IS44, 4'x4'



PS-IS46, 4'x6'

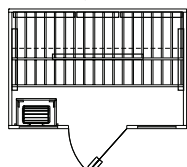

PS-IS55 C, 5'x5'

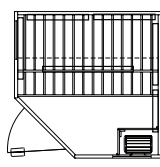

PS-IS57, 5'x7'

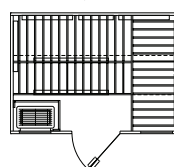

PS-IS66 C, 6'x6'

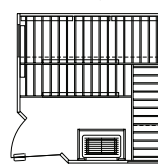

Saunatec's Passport Traditional Sauna Series has become known as one of the best values in traditional saunas. Now the Passport can be upgraded to include the combination InfraSauna.

Passport saunas are easy to assemble with plug-in simplicity, yet are loaded with upgrades usually found only in designer-type saunas. With I/S option added, luxury sauna ownership has never been easier or more affordable.

PORTABLE 2-PERSON INFRAASAUNA™: PASSPORT IS44

For those who sauna bath alone, or with one other—or for those who have limited space—the IS44, 4'x4' two person sauna just might be the best value in the market today. It comes complete, from the factory, with the I/S CarbonFlex® infrared heating panels pre-installed. Simply assemble and plug in to a 120 volt household outlet. The SaunaLogic control panel allows you to easily select “Infrared” or “Traditional” sauna, depending upon what you're in the mood for.

PASSPORT IS46, IS 55c, IS57 AND IS 66c

The full range of Passport saunas—from two person to five person models—can now be ordered with InfraSauna add-on. The larger Passport Saunas come with the I/S CarbonFlex® infrared heating panels uninstalled. After the sauna is assembled, the I/S panels are mounted to the walls according to the instructions provided.



PS-IS 46, 4'x6'

At Left: Exterior and Interior views of PS-IS44

INFRAASAUNA™